

Introducing the new Gripple® Universal Clamp for hanging all types of spiral ductwork within HVAC.

## PRODUCT INFORMATION

- Universal - for spiral 80 to 315 mm diameter
- Up to 6 times faster than traditional methods
- Replaces more than 11 different suspension ring sizes
- Single piece cast construction - not welded
- No tools required for installation
- No risk of losing screws on site
- Inherent vibration insulating properties from the wire rope
- Easy site storage, reduces waste
- Easy to calculate the quantity on a project plan
- Load rated at 45 kg with a safety factor 5:1
- In accordance with DW144



## GRIPPLE CLAMP SPECIFICATION

- Dual connection thread: Ø M8/M10
- Working temperature: -40°C to +110°C
- Reduction in dB (g): 10.2
- Reduction in peak vibration: 69.3%

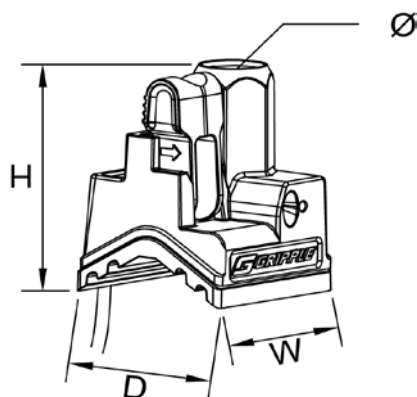

	H (mm)	D (mm)	W (mm)
<b>GC2</b>	39	29.5	29

## WIRE ROPE SPECIFICATION

- 2 mm diameter
- 1.5 m length
- Bespoke length can be made on request
- 7x7 wire rope construction
- 1770 N/mm<sup>2</sup> tensile strength
- Conforms to EN 123485 standard

## REFERENCE

**GC2-PAD-M-1.5 M** with pad and 1.5 m wire rope

## INSULATED PAD SPECIFICATION

- Material: TPE Black Compound
- Type 108004
- Working temperature: -40°C to +110°C
- Melt temperature: +180°C
- Shore hardness A: 60 - 68

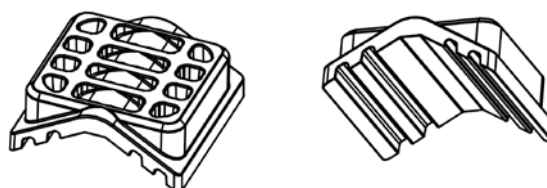

## SPIRAL DUCT INFORMATION CHART

Ø (mm)	Circumference (m)	Thickness (mm)	Weight (kg / m)	Weight (kg / 3 m)
80	0.251	0.5	1.14	3.42
100	0.314	0.5	1.43	4.29
125	0.393	0.5	1.78	5.34
150	0.471	0.5	2.14	6.42
200	0.629	0.6	3.42	10.26
250	0.786	0.6	4.27	12.81
300	0.943	0.6	5.13	15.39
355	1.116	0.8	8.08	24.24
400	1.257	0.8	9.10	27.30
450	1.414	0.8	10.24	30.72
500	1.571	0.8	11.37	34.11
560	1.760	0.8	12.74	38.22
630	1.980	0.8	14.34	43.02

This table is an extract from Lindab® product guide

Recommendation :  
Ø 80 to Ø 315 mm : GC2-PAD-M-1.5 M